

Child Seat Guidelines

Please note that this document serves as a guideline only. There can be variations as the vehicle categories can consist of numerous different vehicle models. No specific vehicle model can be confirmed in advance or guaranteed at any time.

	Infant Seat	Child Seat	Booster Seat	
Age	0-1	1-4	4-9	
Weight	Up to 9 kg	9 - 30 kg	Under 18 kg	Over 18 kg
Direction Facing	Rear	Rear if under 9 kg Rear or Front, if over 9 kg Front, if over 18 kg	Front-facing child seat	Booster seat
no car seat required for children over 145 cm				

NOTE: Children within weight range 9 kg to 18 kg should be kept rear-facing as long as possible.
 (Source: BCAA road-safety / child-passenger-safety)

C-Medium / C-Large Motorhome

2 x three-point belts + 2 tether hooks

2 x infant-, child- or booster seats

2 x lapbelts + 2 tether hooks

2 x child seats

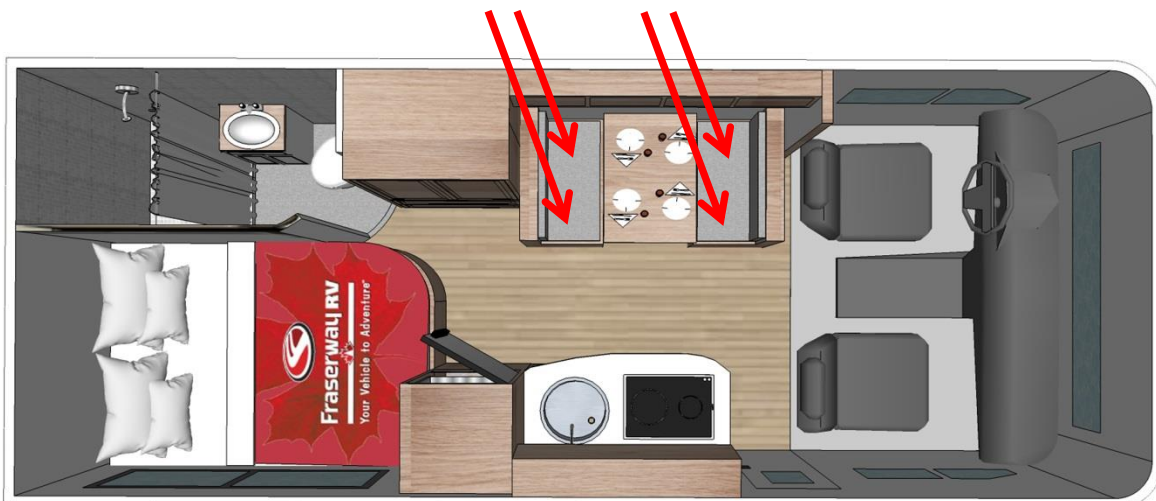

C-XLarge Motorhome

2 x lap belts + 2 tether hooks

2 x infant- or childseats (no booster seats)

Dinette table may need to be lowered when infant seats are installed, meaning no adults can sit in dinette while travelling.

3 x lapbelts

No child seat installation possible

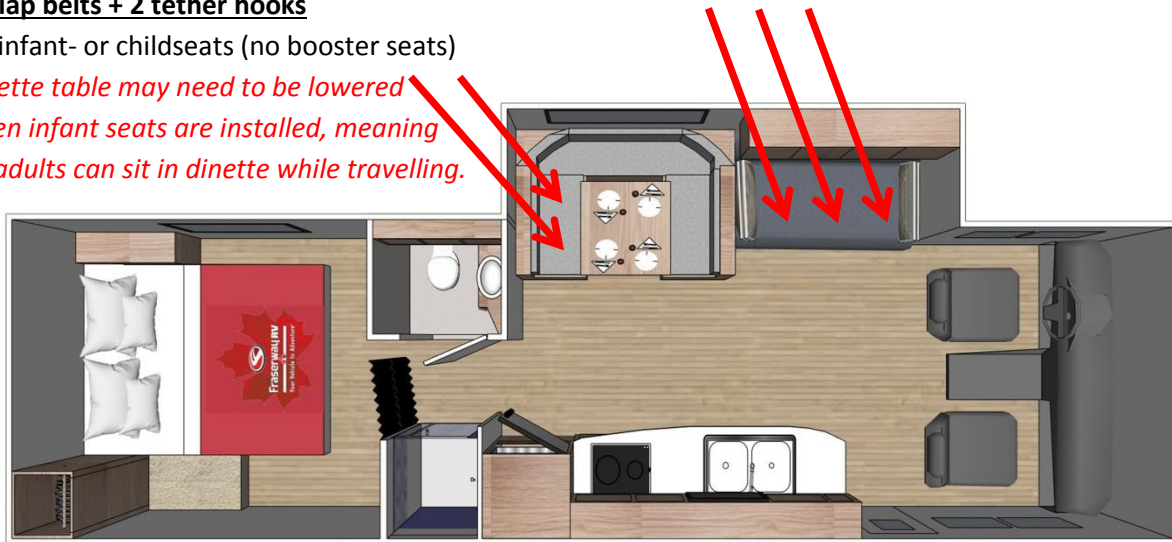

A-Class Motorhome

2 x lap belts + 1 tether hook

1 x infant- or childseat (no booster seat)

Dinette table may need to be lowered when infant seats are installed, meaning no adults can sit in dinette while travelling.

3 x lapbelts

No child seat installation possible

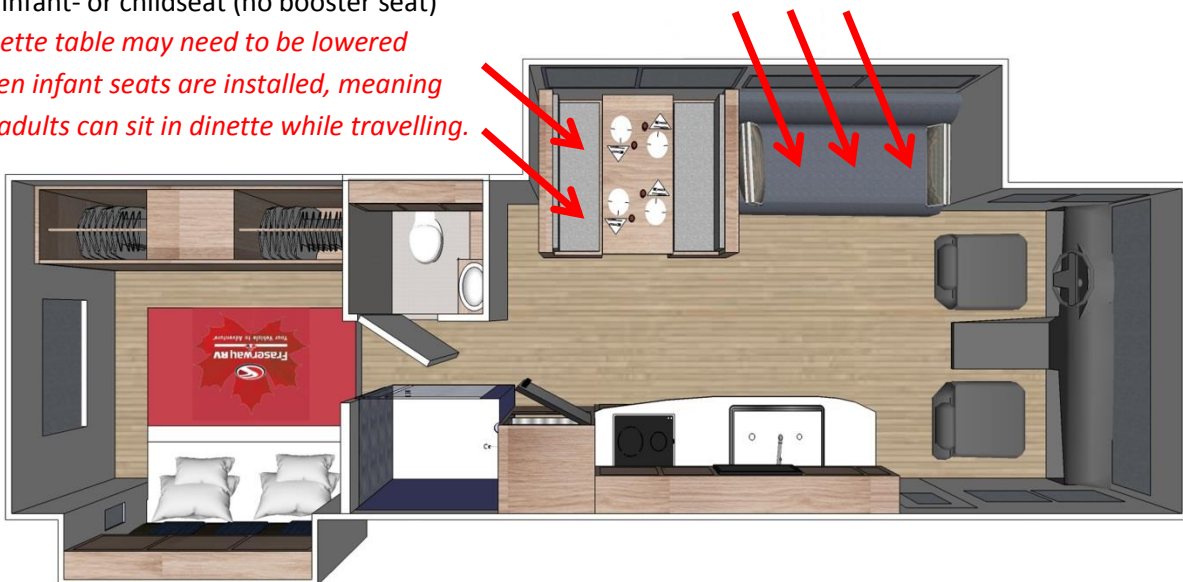

Adventurer 4 Motorhome

2 x three-point belts + 2 tether hooks

2 x infant-, child- or booster seats

2 x lap belts (no tether hooks)

2 adults only

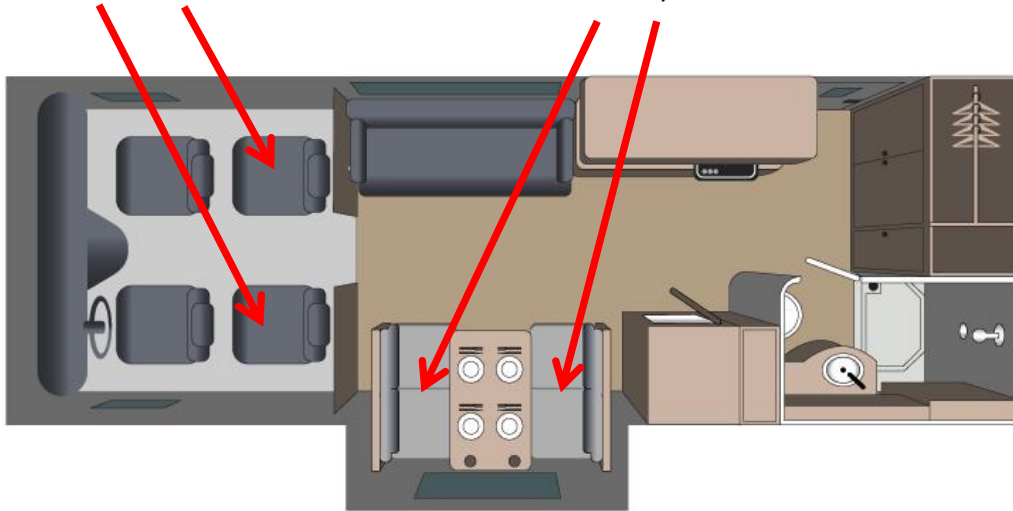

MH27' Wheelchair Accessible

2 x lap belts + 2 tether hooks

2 x infant- or child seats (no booster seats)

Dinette table may need to be lowered when infant seats are installed, meaning no adults can sit in dinette while travelling.

2 x lapbelts + 2 tether hooks

2 x child seats

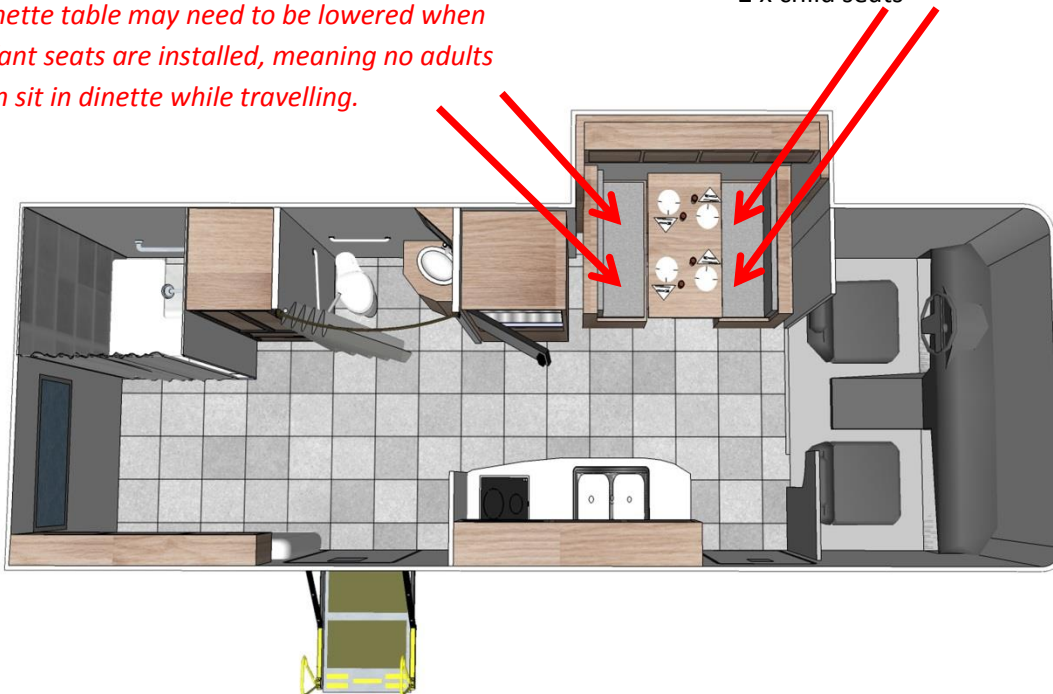

A30 Wheelchair Accessible

2 x lap belts + 1 tether hook

1 x infant- or childseat (no booster seat)

Dinette table may need to be lowered when infant seats are installed, meaning no adults can sit in dinette while travelling.

